

# APC International, Ltd.

TEL: +570-726-6961    FAX +570-726-7466    E-mail: sales@americanpiezo.com

Photo:



Standard type of this sensor:

40T-16AW	Catalog # 10-1095
40R-16AW	Catalog # 10-1100
40T-16P	Catalog # 10-1105
40R-16P	Catalog # 10-1110

Specification:

PARTS NUMBER	40T-16	40R-16
Center frequency (kHz)	40.0±1.0kHz	40.0±1.0kHz
Sound pressure level (0dB=0.0002 μ bar) *	≥ 119dB	-----
Sensitivity (0dB vs 1V/ μ bar) *	-----	≥ -65dB
Bandwidth (kHz)	4.0/112dB	3.5/-71dB
Beam angle -6dB	55°	
Driving voltage (RMS)	30V	
Working temperature (°C)	-30~80	

Dimension(40T/R-16F):

- A=16.1±0.3
- B=12.0±0.4
- C= 9.5±1.0
- D=10.0±0.5
- E=1.0±0.1
- (UNIT: mm)

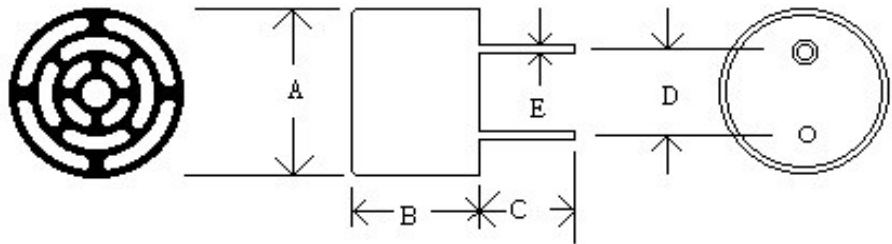

\*Sound Pressure Level: 1 dB vs 0.0002 ubar  
 measuerd at 10Vrms, 30 cm distance  
 \*Sensitivity: 0dB vs 1V/ubar, 30 cm distance

Sound pressure level

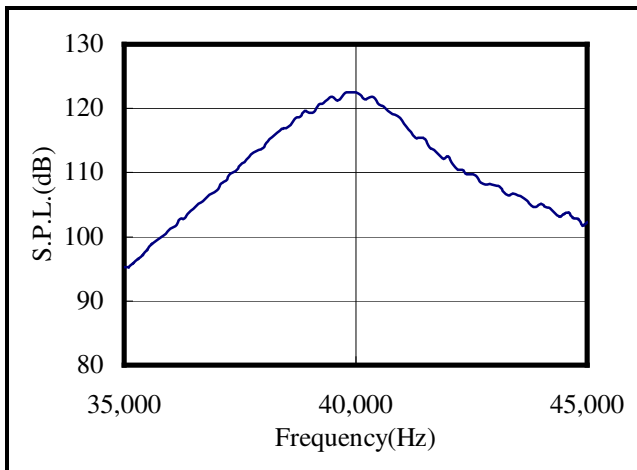

Sensitivity

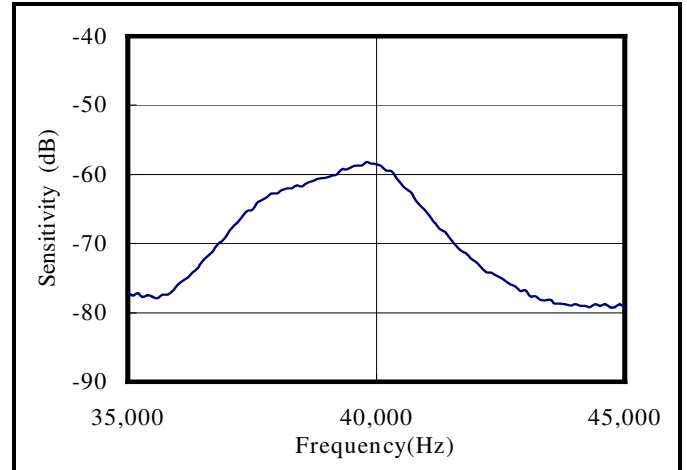

Transmitter impedance

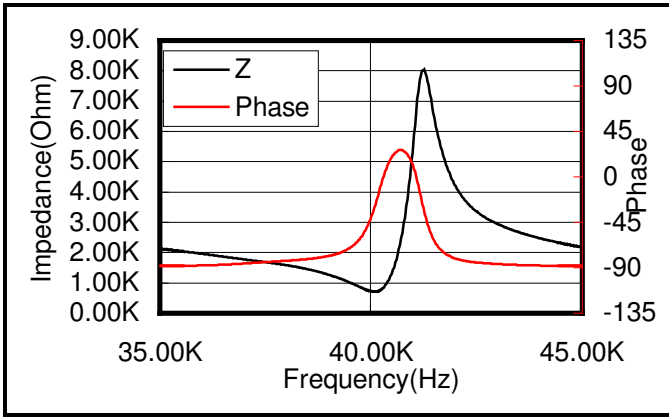

Receiver impedance

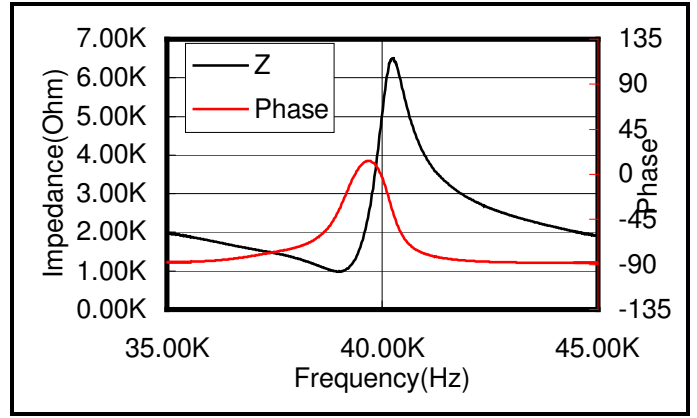

Beam angle of transmitter

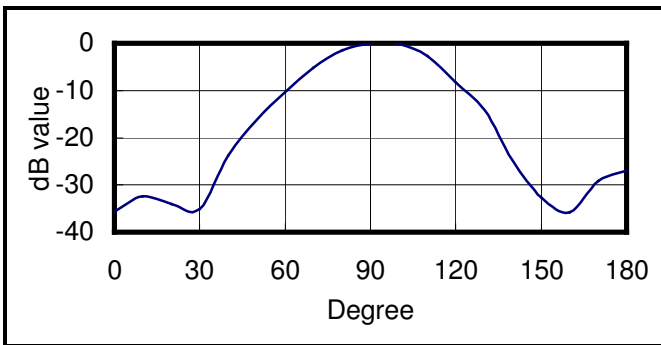

Beam angle of receiver

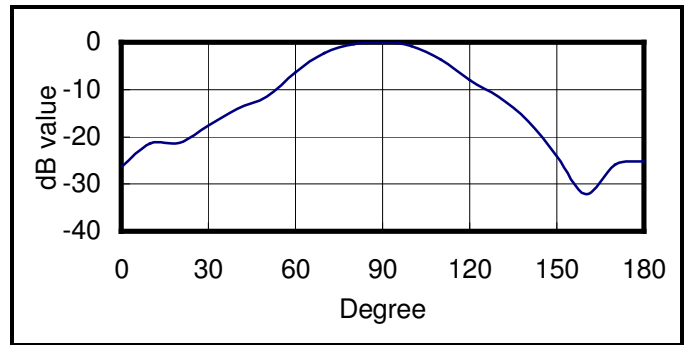

Environment test

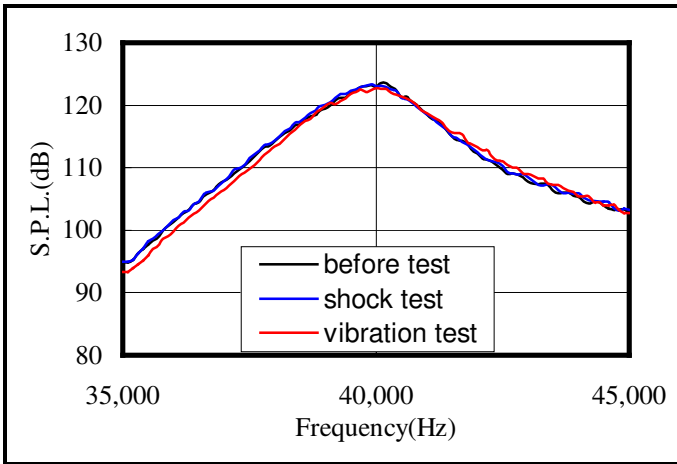

Temperature test

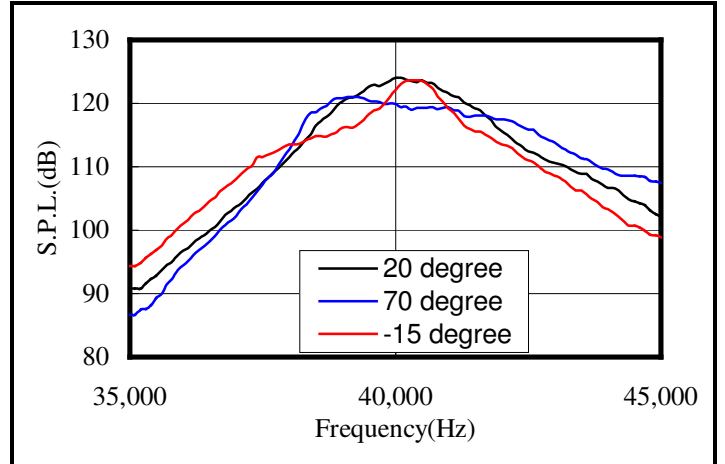

Sensitivity change with load resistance

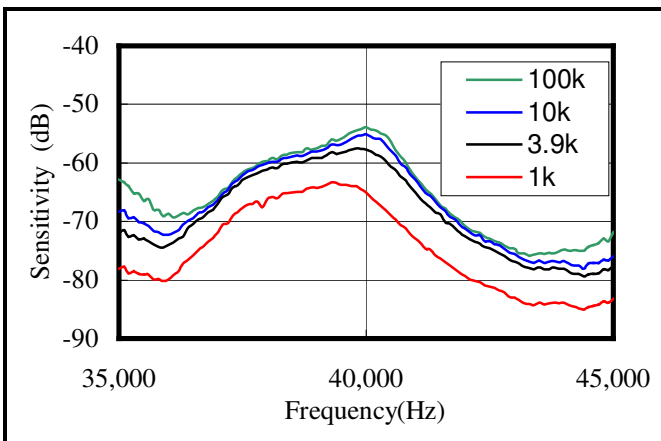

S.P.L. change with driving voltage

